

HCD096205 TYPE

TYPE

HCD 096205

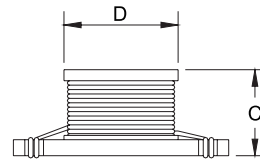
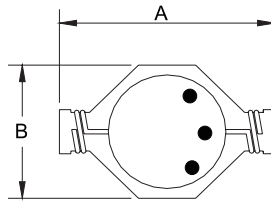

A: 8.9 MAX
B: 6.73 MAX
C: 5.0 MAX
D: 4.5±0.5

SPECIFICATION

ITEM	L	DCR	SRF	IDC1	IDC2
HCD096205	(μ H)	MAX(Ω)	MIN(MHz)	MAX(A)	MAX(A)
R56M	0.56±20%	0.010	200	7.7	6.0
1R2M	1.2±20%	0.017	140	5.3	4.4
2R2M	2.2±20%	0.035	100	3.5	3.1
4R7M	4.7±20%	0.054	50	2.6	2.2
100M	10±20%	0.111	40	1.9	1.5
150M	15±20%	0.170	30	1.5	1.2
220M	22±20%	0.250	25	1.2	1.0
330M	33±20%	0.370	20	0.99	0.8
470M	47±20%	0.470	15	0.87	0.7

J: ±5%, K: ±10%, M: ±20%

* Hong can design any part to your requirements with different inductance.

* All parameters as this content presented are subject to final specifications both sides confirmed.